

An updated drawing illustrating the proposed drawpits
and ducting layout plan

DRAWPIT SCHEDULE

DRAWPIT NO.	L.		W.		D.
A	1200	X	1200	X	850
C	2000	X	2000	X	1200
D	3000	X	2000	X	1200
CABLE JOINT PIT 1	8000	X	2000	X	1200
CABLE JOINT PIT 2	8000	X	2000	X	1200

⑥ : TOTAL 6 NOS. Ø150 HDPE/UPVC PIPE WITH CONCRETE SURROUND

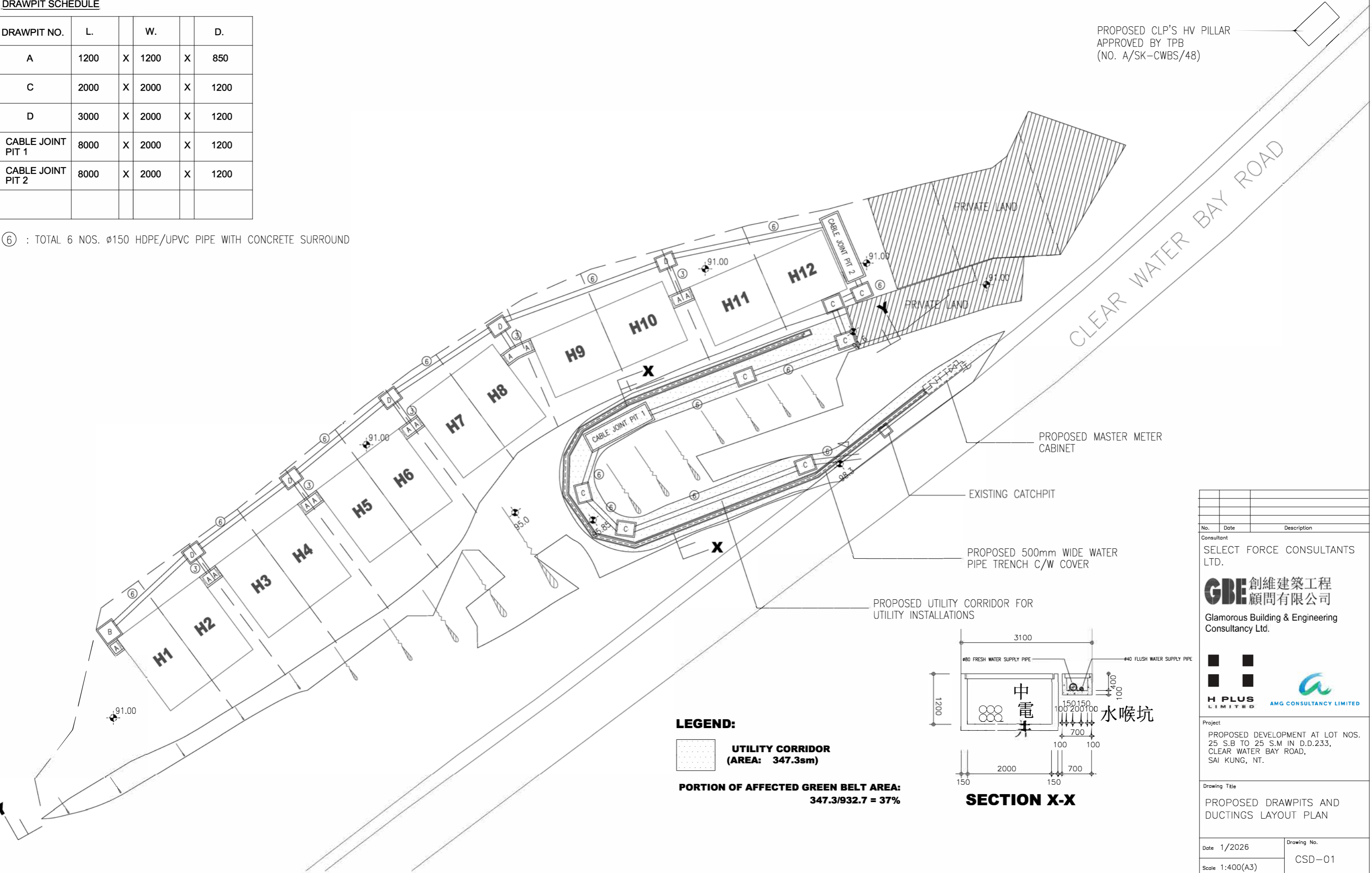

PROPOSED CLP'S HV PILLAR
APPROVED BY TPB
(NO. A/SK-CWBS/48)

PROPOSED MASTER METER
CABINET

EXISTING CATCHPIT

PROPOSED 500mm WIDE WATER
PIPE TRENCH C/W COVER

PROPOSED UTILITY CORRIDOR FOR
UTILITY INSTALLATIONS

LEGEND:

 **UTILITY CORRIDOR**
(AREA: 347.3sm)

PORTION OF AFFECTED GREEN BELT AREA:
347.3/932.7 = 37%

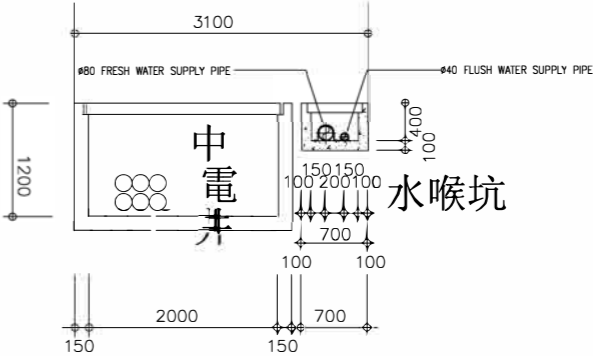

SECTION X-X

No.	Date	Description
Consultant		
SELECT FORCE CONSULTANTS LTD.		
 創維建築工程 顧問有限公司		
Glamorous Building & Engineering Consultancy Ltd.		
 		
Project		
PROPOSED DEVELOPMENT AT LOT NOS. 25 S.B TO 25 S.M IN D.D.233, CLEAR WATER BAY ROAD, SAI KUNG, NT.		
Drawing Title		
PROPOSED DRAWPITS AND DUCTINGS LAYOUT PLAN		
Date	1/2026	Drawing No.
Scale	1:400(A3)	CSD-01
Drawn	MFY	Rev. No.
Checked	MFY	A
Approved		